

Deburring Cutter

Entgratfräser

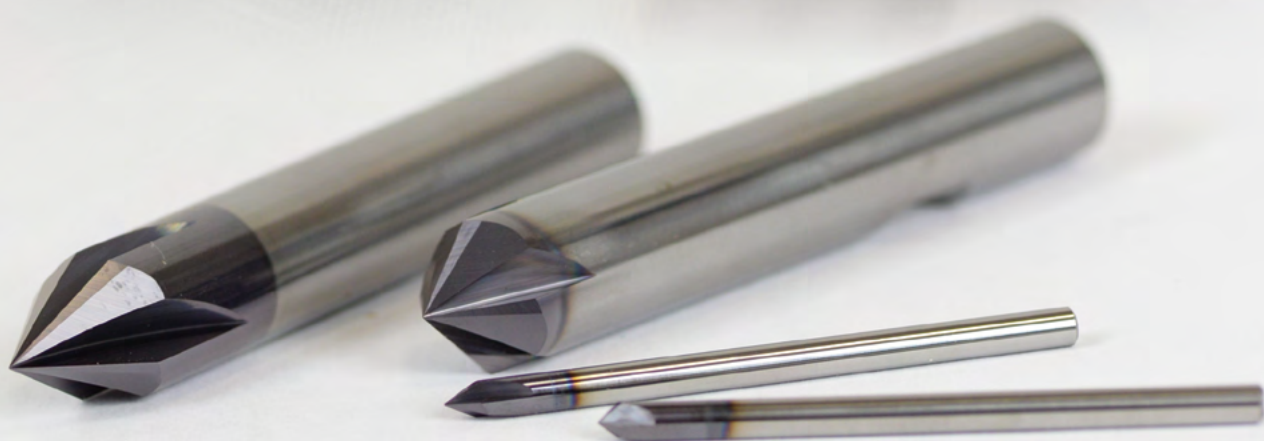

ZCC Cutting Tools Europe GmbH

your Partner | your Value

Deburring Cutter · Entgratfräser

Deburring Cutter 90° Entgratfräser 90°

5501/5601



Coating
Coated

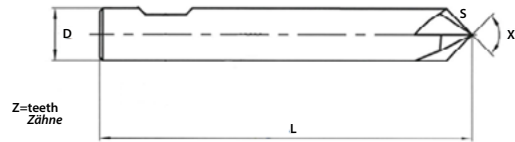

Article no. Artikel Nr.	Dimension (mm) Abmessung					Shank Schaft	P M K Grade / Sorte KMG 303
	D	L	S	Z	X		
5501R903FM-0300	3	48	2.1	3	90	HA	●
5501R904FM-0400	4	48	2.8	4	90	HA	●
5601R904FM-0600	6	55	4.2	4	90	HB	●
5601R904FM-0800	8	58	5.6	4	90	HB	●
5601R904FM-1000	10	65	7.0	4	90	HB	●
5601R904FM-1200	12	75	8.5	4	90	HB	●
5601R904FM-1600	16	85	11.3	4	90	HB	○
5601R906FM-1000	10	65	7.0	6	90	HB	●
5601R906FM-1200	12	75	8.5	6	90	HB	●
5601R906FM-1600	16	85	11.3	6	90	HB	○

Deburring Cutter 60° Entgratfräser 60°

5501/5601



Coating
Coated

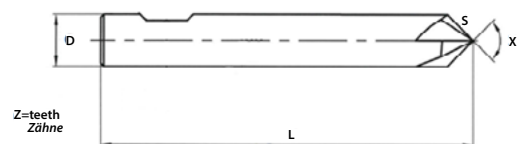

Article no. Artikel Nr.	Dimension (mm) Abmessung					Shank Schaft	P M K Grade / Sorte KMG 303
	D	L	S	Z	X		
5501R603FM-0300	3	48	3	3	60	HA	●
5501R604FM-0400	4	48	4	4	60	HA	●
5601R604FM-0600	6	55	6	4	60	HB	●
5601R604FM-0800	8	58	8	4	60	HB	●
5601R604FM-1000	10	65	10	4	60	HB	●
5601R604FM-1200	12	75	12	4	60	HB	●
5601R604FM-1600	16	85	16	4	60	HB	○
5601R606FM-1000	10	65	10	6	60	HB	●
5601R606FM-1200	12	75	12	6	60	HB	●
5601R606FM-1600	16	85	16	6	60	HB	○

Corner Radius Cutter Viertelkreisfräser

5601

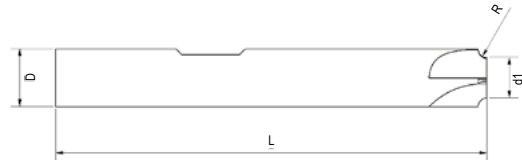

Coating
Coated

Article no. Artikel Nr.	Dimension (mm) Abmessung					Shank Schaft	P M K Grade / Sorte KMG 303
	d1	D	L	Z	R		
5601R904FM-R02-0600	5.6	6	60	4	0.2	HB	•
5601R904FM-R03-0600	5.4	6	60	4	0.3	HB	•
5601R904FM-R04-0600	5.2	6	60	4	0.4	HB	•
5601R904FM-R05-0800	7.0	8	70	4	0.5	HB	•
5601R904FM-R06-0800	6.8	8	70	4	0.6	HB	•
5601R904FM-R075-0800	6.5	8	70	4	0.75	HB	•
5601R904FM-R08-0800	6.4	8	70	4	0.8	HB	•
5601R904FM-R10-0800	6.0	8	70	4	1.0	HB	•
5601R904FM-R15-1000	7.0	10	75	4	1.5	HB	•
5601R904FM-R20-1000	6.0	10	75	4	2.0	HB	•
5601R904FM-R25-1200	7.0	12	75	4	2.5	HB	•
5601R904FM-R30-1200	6.0	12	75	4	3.0	HB	•
5601R904FM-R40-1600	8.0	16	80	4	4.0	HB	•
5601R904FM-R50-2000	10.0	20	80	4	5.0	HB	•

Quarter Radius Cutter
Viertelkreisfräser

Recommended Cutting Data Empfohlene Schnittdaten

Material Werkstoffe		D (mm)	Vc (m/min)	Feed rate Vorschub fz (mm/Z)	Material Werkstoffe		D (mm)	Vc (m/min)	Feed rate Vorschub fz (mm/Z)
P	Steel Stahl	3	70-120	0,01	K	Cast iron Guss	3	90	0,01
		4	70-120	0,02			4	90	0,02
		6	70-120	0,03			6	90	0,03
		8	70-120	0,04			8	90	0,04
		10	70-120	0,05			10	90	0,05
		12	70-120	0,06			12	90	0,06
		16	70-120	0,08			16	90	0,08
M	Stainless Steel Rostfreier Stahl	3	60-90	0,01	N	Non ferrous Materials Ne-Metalle	3	200-280	0,01
		4	60-90	0,02			4	200-280	0,02
		6	60-90	0,03			6	200-280	0,03
		8	60-90	0,04			8	200-280	0,04
		10	60-90	0,05			10	200-280	0,05
		12	60-90	0,06			12	200-280	0,06
		16	60-90	0,08			16	200-280	0,08



Scan for PDF

Englisch
Deutsch



Vertriebszentrale in Europa
Sales center in Europe

ZCC Cutting Tools Europe GmbH

www.zccct-europe.com

Heltorfer Straße 12, 40472 Düsseldorf, Germany

Tel.: +49(0)211-989240-0

Fax: +49(0)211-989240-111

E-mail: info@zccct-europe.com

Vertretung
Distributor

© Copyright by ZCC Cutting Tools Europe GmbH
All rights reserved / Alle Rechte vorbehalten.

All rights reserved. All descriptions and pictures are protected by copyright. Usage, modification and reproduction, completely or partially, without written permission are prohibited. Subject to technical changes and changes of the delivery program. Mistakes and printing errors are reserved.

Alle Rechte vorbehalten. Alle Beschreibungen und Abbildungen sind urheberrechtlich geschützt. Die Verwendung, Modifikation und Vervielfältigung, ganz oder teilweise, ohne schriftliche Genehmigung sind untersagt. Technische Änderungen und Änderungen des Lieferprogrammes vorbehalten. Für Druckfehler und Irrtümer keine Gewähr.